

- CONSTRUCTION NOTES: QTY:**
- 1) PROTECT IN PLACE. (AS NOTED ON PLAN).
 - 2) REMOVE EXISTING AC PAVEMENT. _____ XXXX SF
 - 3) REMOVE EXISTING CONCRETE PAD OR PAVEMENT. _____ XXXX SF
 - 4) REMOVE EXISTING CONCRETE CURB OR CURB AND-GUTTER. _____ XXXX LF
 - 5) REMOVE EXISTING CONCRETE V-GUTTER. _____ XXXX LF
 - 6) REMOVE EXISTING TREE. _____ XX EA
 - 7) REMOVE EXISTING SIGN AND-POST. _____ XX EA
 - 8) REMOVE EXISTING HALL. _____ XX LF
 - 9) REMOVE EXISTING GUARD POST. _____ XX EA
 - 10) REMOVE EXISTING LOT LIGHT. _____ XX EA
 - 11) RELOCATE EXISTING POST INDICATOR VALVE. _____ XX EA
 - 12) RELOCATE EXISTING FIRE HYDRANT. _____ XX EA
 - 13) ADJUST TO GRADE EXISTING DWP VAULT. _____ XX EA
 - 14) RELOCATE SIGN. _____ XX EA
 - 15) ADJUST CLEANOUT TO GRADE EXISTING SEWER CLEANOUT. _____ XX EA
 - 16) REMOVE EXISTING STAIRS. _____ XX EA
 - 17) REMOVE EXISTING AC CURB/BERM. _____ XXXX LF
 - 18) REMOVE EXISTING STORM DRAIN PIPE. _____ XXXX LF
 - 19) REMOVE EXISTING FENCE. _____ XX LF
 - 20) REMOVE EXISTING TRASH ENCLOSURE. _____ XX EA
 - 21) REMOVE EXISTING MONUMENT SIGN. _____ XX EA
 - 22) REMOVE EXISTING GUARD SHACK. _____ XX EA
 - 23) REMOVE EXISTING CONCRETE CHANNEL.
 - 24) REMOVE EXISTING LANDSCAPE AND IRRIGATION PER LANDSCAPE PLANS
 - 25) REMOVE EXISTING CATCH BASIN AND SUMP PUMP

SEE GP XXX

SEE GP XXX

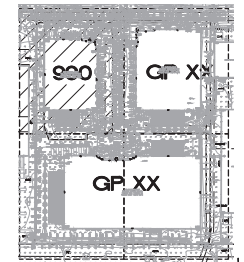
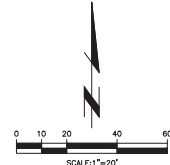

BENCHMARK:
CITY OF LOS ANGELES BENCHMARK NO. "21-02291"
LEAD AND TAG IN SOUTHEAST CURB RETURN KNOX STREET AND
NORMANDIE AVENUE; 13.5 FEET NORTH OF BORN SOUTH OF KNOX STREET
ELEVATION = 49.776 FEET (NAVD '88 / 2014 ADL)

SOILS ENGINEER:

REV.	DESCRIPTION	DATE	APPR'D



PLANS PREPARED UNDER THE SUPERVISION OF:
030520
01/09/20
BENJAMIN STINDEL
R.C.E. 56155 - EXP. 12-31-20

ENGINEER:
TAI Thines Engineering, Inc.
CIVIL ENGINEERING AND SURVEYING
1001 S. WINDMILL AVE
TORRANCE, CA 90502
TEL: (562) 481-1111 FAX: (562) 481-4113

OWNER:
COOING PACIFIC GATEWAY LLC
1001 S. WINDMILL AVE
TORRANCE, CA 90502

CITY OF LOS ANGELES
DEMOLITION PLAN
FOR
AMAZON DCX7 TORRANCE
990 FRANCISCO STREET
LOS ANGELES

SHEET	2
OF	7
T.E. 208 No. 3502	

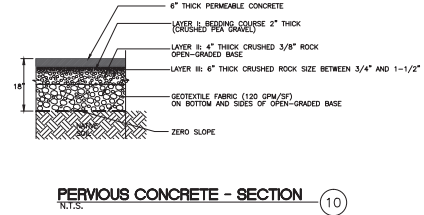
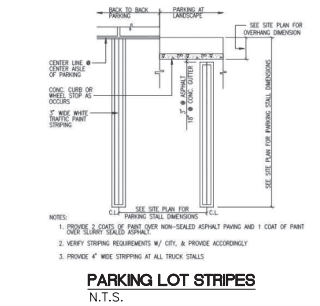
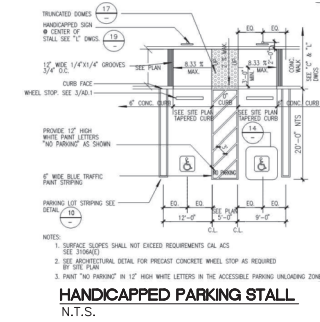
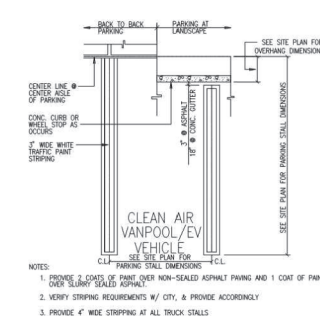
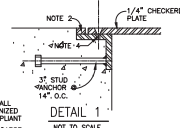
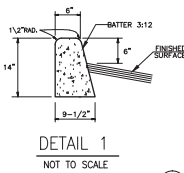
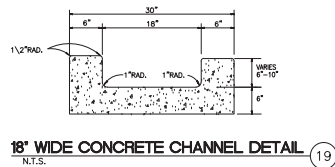
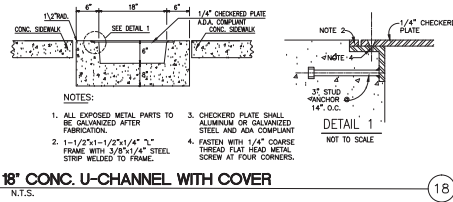
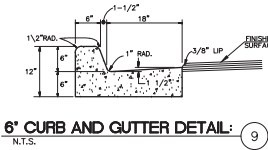
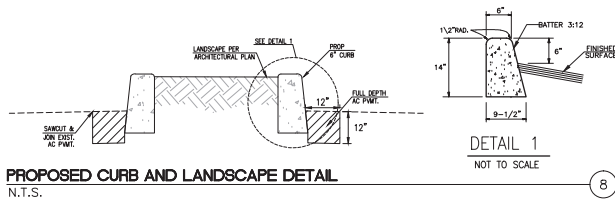

NOTE:
PARKING, AND ADA, SIGNAGE & STRIPING PER ARCHITECTURAL PLANS

HATCH LEGEND:

 PROPOSED LANDSCAPE PER ARCHITECTURAL PLAN.
 NEW AC PAVEMENT (MATCH EXIST. PAVEMENT)
 PROPOSED CONCRETE.



BENCHMARK:
CITY OF LOS ANGELES BENCHMARK NO. "21-02291"
LEAD AND TAG IN SOUTHEAST CURB RETURN KNOX STREET AND NORMANDIE AVENUE, 13.5 FEET NORTH OF BORN SOUTH OF KNOX STREET
ELEVATION = 49.776 FEET (NAVD '88 / 2014 ADL)

REV.	DESCRIPTION	DATE	APPR'D



PLANS PREPARED UNDER THE SUPERVISION OF:
 03/25/20
 04/09/20
 R.C.E. 56155 - EXP. 12-31-20

ENGINEER:
 TAI Thienes Engineering, Inc.
 CIVIL ENGINEERING & LAND SURVEYING
 14349 FIRESTONE BOLLING RD
 LA BARRA, CALIFORNIA 90438
 PH: (760) 881-4811 FAX: (760) 881-4113

OWNER:
 COCONG PACIFIC GATEWAY LLC
 1001 S. VENICE AVE
 TORRANCE, CA 90502

CITY OF LOS ANGELES

CROSS SECTIONS AND DETAILS

FOR
AMAZON DCX7 TORRANCE
 990 FRANCISCO STREET
 LOS ANGELES

SHEET **3**
 OF **7**
 T.E. 208 No. 3952

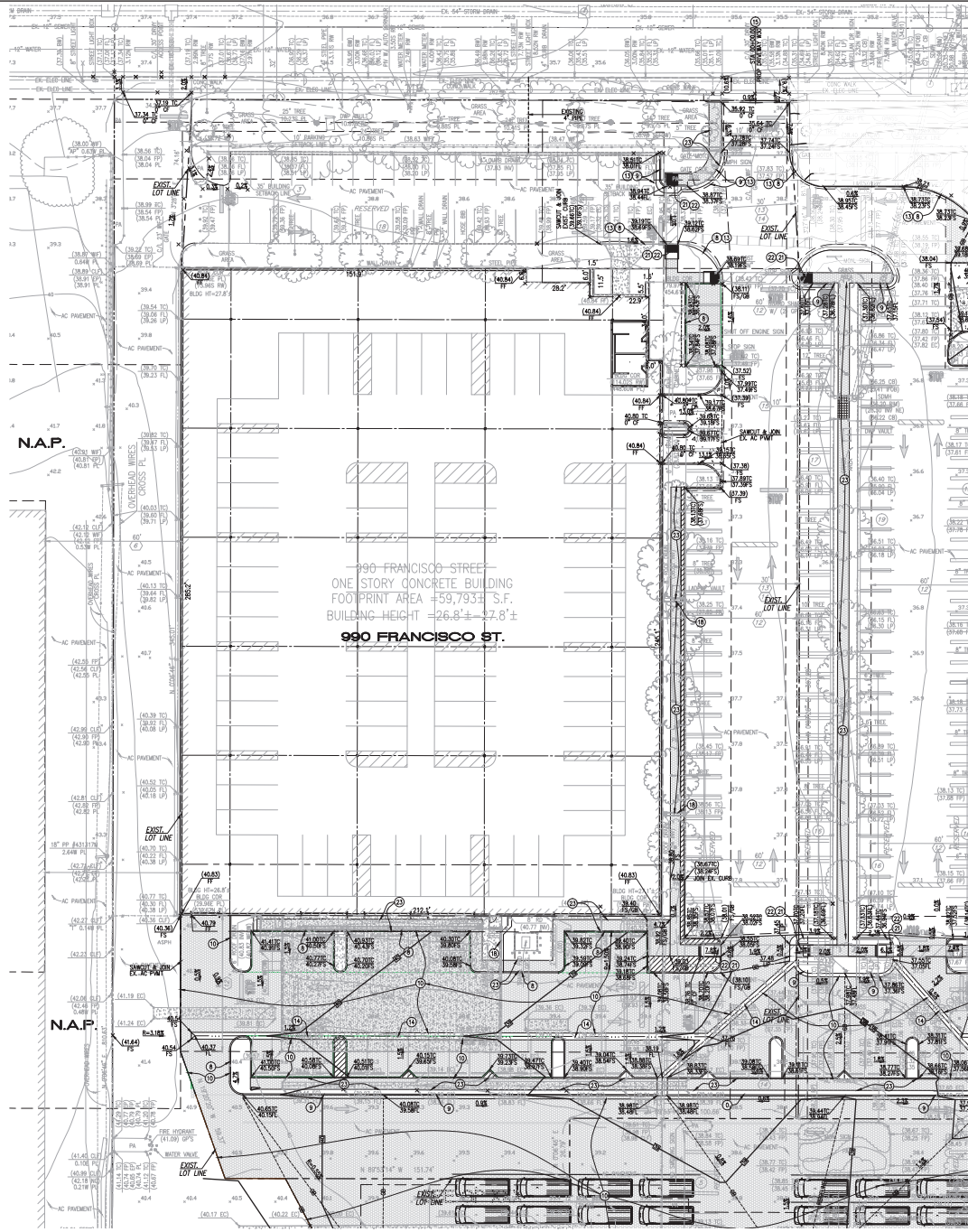

CONSTRUCTION NOTES:

- 1 PROTECT IN PLACE. (AS NOTED ON PLAN).
- 2 ADJUST TO GRADE EXISTING WATER VALVE
- 3 ADJUST TO GRADE EXISTING WATER VAULT
- 4 ADJUST TO GRADE EXISTING SEWER CLEANOUT
- 5
- 6
- 7
- 8 CONSTRUCT 6" CURB PER DETAIL ON SHT. 2.
- 9 CONSTRUCT 6" CURB AND GUTTER PER DETAIL ON SHT. 2 PER DETAIL ON SHEET 2.
- 10 CONSTRUCT PERVIOUS CONCRETE PAVEMENT PER DETAIL ON SHT. 2
- 11 CONSTRUCT CONC. PAVEMENT (PER SOIL ENGR'S RECOMMENDATION)
- 12 CONSTRUCT AC PAVEMENT (PER SOIL ENGR'S RECOMMENDATION)
- 13 CONSTRUCT FULL DEPTH A.C. (12" MIN.)
- 14 CONSTRUCT CONCRETE 3" V-GUTTER PER DETAIL ON SHT. 2.
- 15 CONSTRUCT DRIVEWAY PER CITY OF LA STD. S-440-4
- 16 CONSTRUCT 8" TYPE C INTEGRAL CURB AND GUTTER PER CITY OF LOS ANGELES STD. S-415-2.
- 17 CONSTRUCT SIDEWALK PER CITY OF LOS ANGELES STD. S-444-5.
- 18 CONSTRUCT SIDEWALK UNDERDRAIN PER DETAIL ON SHT. 2 W/PAV PLAN.
- 19 CONSTRUCT 18" WIDE CONCRETE CHANNEL PER DETAIL ON SHT. 2
- 20 CONSTRUCT SLURRY SEAL PER CITY OF LOS ANGELES SPECIFICATION.
- 21 CONSTRUCT CURB RAMP PER DETAIL ON SHT. 2
- 22 CONSTRUCT DETECTABLE WARNING SURFACE PER S.S.P.W.C. STD. NO. 111-5
- 23 CONSTRUCT PERVIOUS CONCRETE WALKWAY PER DETAIL ON SHT. 2
- 24 LANDSCAPE PER SEPARATE LANDSCAPE PLAN.
- 25 GUARD POST PER ARCHITECTURAL PLANS.
- 26 RETAINING WALL PER SEPARATE PLAN AND PERMIT (PER STRUCTURAL PLANS)

SEE GP XXX

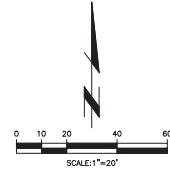
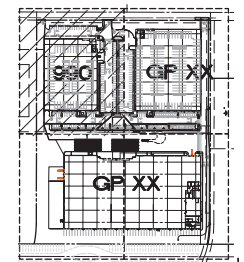

Know what's below.
Call before you dig.

BENCHMARK:
CITY OF LOS ANGELES BENCHMARK NO. "21-02291"
LEAD AND TAG IN SOUTHEAST CURB RETURN KNOX STREET AND
NORMANDE AVENUE, 13.5 FEET NORTH OF BORN SOUTH OF KNOX STREET
ELEVATION = 49.776 FEET (NAVD '88 / 2014 ADL)

SOILS ENGINEER:

REV.	DESCRIPTION	DATE	APPR'D



PLANS PREPARED UNDER THE SUPERVISION OF:
Richard Stengel
RICHARD STENDEL
R.C.E. 56155 - EXP. 12-31-20

ENGINEER:
TAI Thines Engineering, Inc.
CIVIL ENGINEERING AND SURVEYING
1071 S. WINDMILL RD
TORRANCE, CALIFORNIA 90503
TEL: (562) 481-1111 FAX: (562) 481-4113

OWNER:
COOGING PACIFIC GATEWAY LLC
1071 S. WINDMILL RD
TORRANCE, CA 90502

CITY OF LOS ANGELES

GRADING PLAN

FOR
AMAZON D0X7 TORRANCE
990 FRANCISCO STREET
LOS ANGELES

SHEET	4
OF	7
T.E. 208	Rev. 05/22

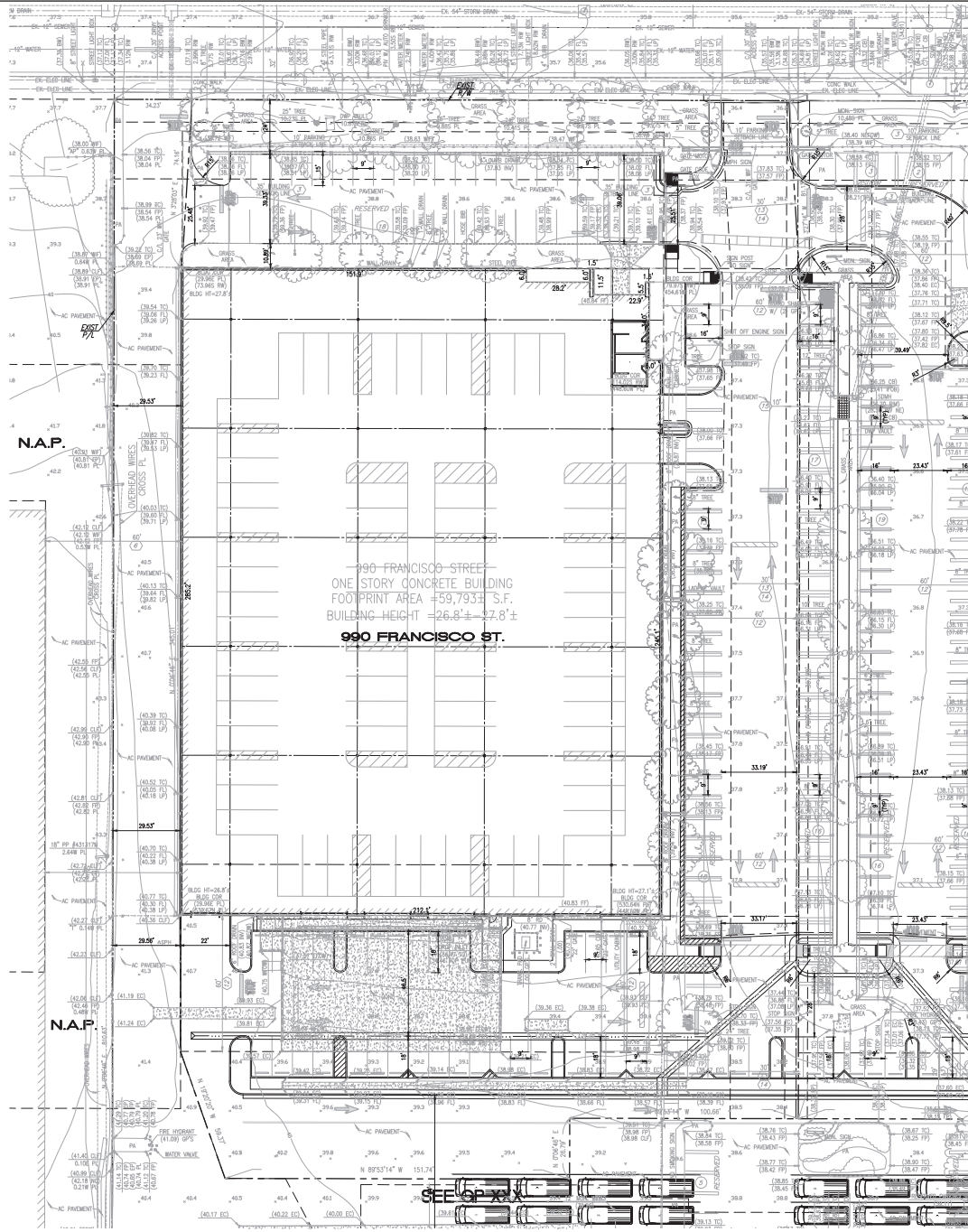

990 FRANCISCO STREET
 ONE STORY CONCRETE BUILDING
 FOOTPRINT AREA = 59,793± S.F.
 BUILDING HEIGHT = 26.8' ± ± 27.8' ±

SEE GP XXX

SEE GP XXX

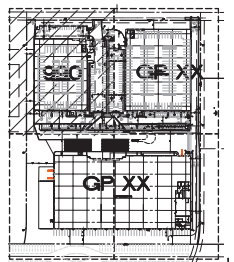

INDEX MAP
 SCALE: 1"=150'

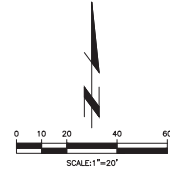

Know what's below.
 Call before you dig.

BENCHMARK:
 CITY OF LOS ANGELES BENCHMARK NO. "21--02291"
 LEAD AND TAG IN SOUTHEAST CURB RETURN KNOX STREET AND
 NORMANDE AVENUE, 13.0 FEET NORTH OF BORN SOUTH OF KNOX STREET
 ELEVATION = 49.776 FEET (NAVD '88 / 2014 ADL)

SOILS ENGINEER:

REV.	DESCRIPTION	DATE	APPR'D.



PLANS PREPARED UNDER
 THE SUPERVISION OF:
R. G. S. P.
 REGISTERED PROFESSIONAL ENGINEER
 N.E.C.E. 56155 - EXP. 12-31-20

ENGINEER:
TAO Thines Engineering, Inc.
 CIVIL ENGINEERING & LAND SURVEYING
 1701 S. WINDY HILL
 LA BREA, CALIFORNIA 90008
 (310) 461-4111 FAX (310) 411-4113

OWNER:
 COOGING PACIFIC GATEWAY LLC
 1101 S. WINDY HILL
 TORRANCE, CA 90502

CITY OF LOS ANGELES

DIMENSIONAL PLAN

FOR
AMAZON DCX7 TORRANCE
 990 FRANCISCO STREET
 LOS ANGELES

SHEET **5**
 OF **7**
 I.L. 208 No. 3852

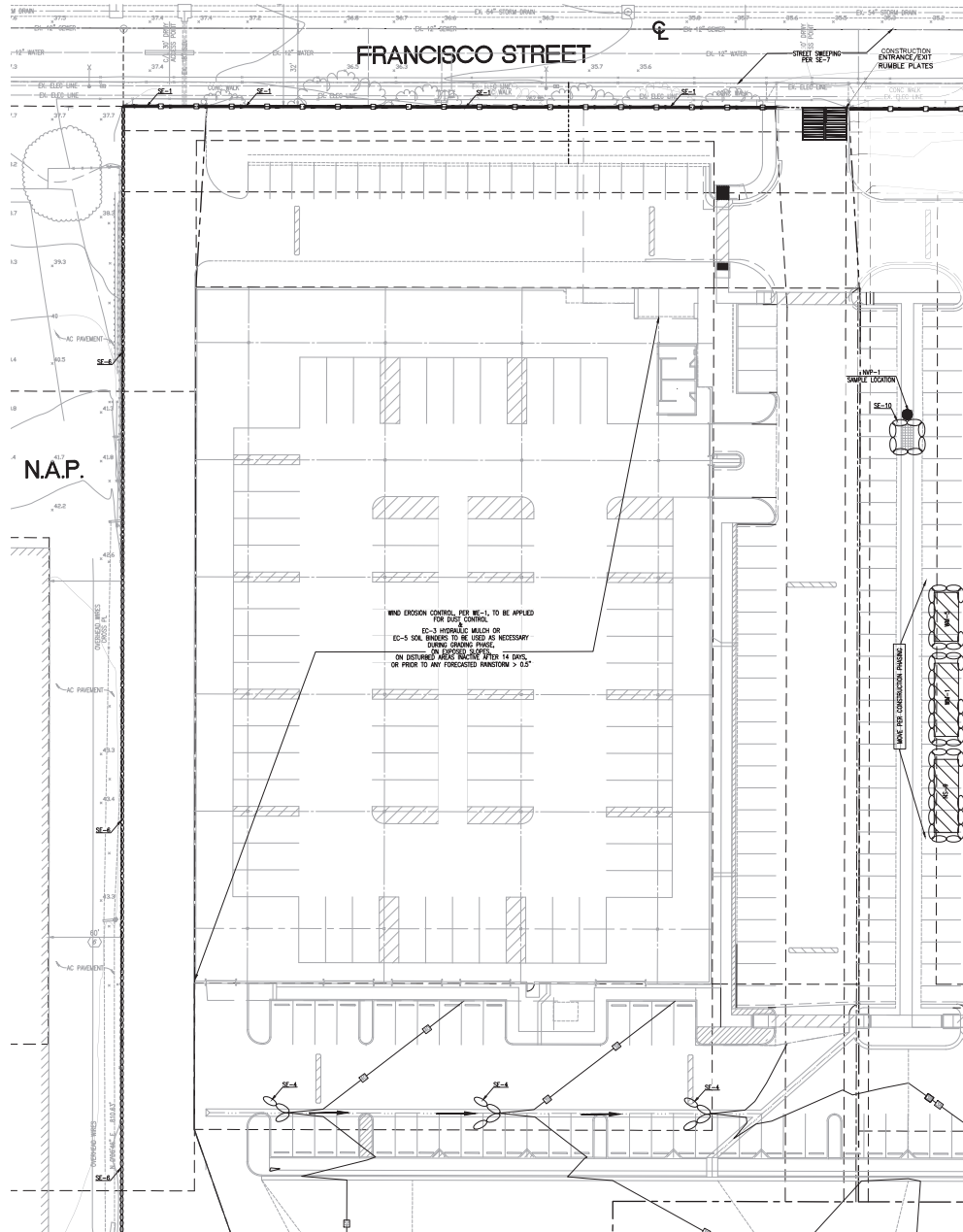

LEGEND

- EMP STABILIZED CONSTRUCTION ENTRANCE
- SE-1 SILT FENCE
- SE-4 CHECK DAM
- SE-6 GRAVEL BAG BERM
- SE-7 STREET SWEEPING AND VACUUMING
- SE-10 STORM DRAIN INLET PROTECTION
- NE-8 VEHICLE AND EQUIPMENT CLEANING
- NE-9 VEHICLE AND EQUIPMENT FUELING
- WM-1 MATERIAL DELIVERY AND STORAGE
- WM-3 STOCKPILE MANAGEMENT
- WM-5 SOLID WASTE MANAGEMENT
- WM-8 CONCRETE WASTE MANAGEMENT
- WM-9 SANITARY/SEPTIC WASTE MANAGEMENT
- WE-1 WIND EROSION CONTROL

SYMBOL

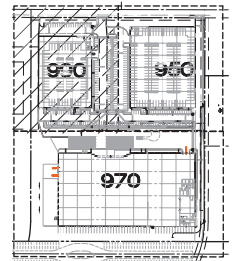

SITE PLAN
SCALE: 1"=150'



BENCHMARK:
CITY OF LOS ANGELES BENCHMARK NO. "21-02291"
LEAD AND TAG IN SOUTHEAST CURB RETURN KNOX STREET AND NORMANDE AVENUE, 13.5 FEET NORTH OF BORN SOUTH OF KNOX STREET
ELEVATION = 49.776 FEET (NAVD '88 / 2014 ADL)

REV.	DESCRIPTION	DATE	APPR'D



PLANS PREPARED UNDER THE SUPERVISION OF:
Richard Stenzel
RICHARD STENZEL
R.C.E. 56155 - EXP. 12-31-20

ENGINEER:
TAI Thienes Engineering, Inc.
CALIFORNIA ENGINEERING & LAND SURVEYING
2424 FIRESTONE BOLLINGWOOD
LA BARRA, CALIFORNIA 90638
PH: (760) 881-4111 FAX: (760) 881-4113

OWNER:
COCONA PACIFIC GATEWAY LLC
1101 S. WINDMILL AVE
TORRANCE, CA 90502

CITY OF LOS ANGELES		SHEET
EROSION CONTROL PLAN		6
FOR AMAZON DCX7 TORRANCE		OF 7
990 FRANCISCO STREET LOS ANGELES		T.E. 208 Rev. 3/202

EROSION AND SEDIMENT CONTROL PLAN (ESCP)
GENERAL NOTES:

- IN CASE OF EMERGENCY, CALL AT 1-800-AC-EROSION.
- TOTAL DISTURBED AREA SHALL BE AS LOW AS FEASIBLE.
- A STAND-BY CREW FOR EMERGENCY WORK SHALL BE AVAILABLE AT ALL TIMES DURING THE RAINY SEASON (NOVEMBER 1 TO APRIL 15). NECESSARY MATERIALS SHALL BE AVAILABLE ON-SITE AND STOCKPILED AT CONVENIENT LOCATIONS TO FACILITATE RAPID CONTRIBUTION OF EMERGENCY DEVICES WITHIN RAIN OR IMMINENT THREAT OF RAIN.
- EROSION CONTROL DEVICES SHOWN ON THIS PLAN MAY BE REMOVED WHEN APPROVED BY THE BUILDING OFFICIAL IF THE GRADING OPERATION HAS PROCEEDED TO THE POINT WHERE THEY ARE NO LONGER REQUIRED.
- GRADED AREAS ADJACENT TO FILL SLOPES LOCATED AT THE SITE FORMERLY MUST DRAIN AWAY FROM THE TOP OF SLOPES AT THE CONCLUSION OF EACH WORKING DAY. ALL LOOSE SOILS AND DEBRIS THAT MAY CREATE A POTENTIAL HAZARD TO LEFT-SITE PROPERTIES SHALL BE STABILIZED OR REMOVED FROM THE SITE ON DAILY BASIS.
- ALL SILT AND DEBRIS SHALL BE REMOVED FROM ALL DEVICES WITHIN 24 HOURS AFTER EACH RAIN EVENT. THE DEVICES SHALL BE SHOWN OR PUMPED DRY WITHIN 24 HOURS AFTER EACH RAINFALL. PUMPING AND DRAINING OF ALL BASINS AND DRAINAGE DEVICES MUST COMPLY WITH THE APPROPRIATE BMP FOR DRAINAGE OPERATIONS.
- THE PLACEMENT OF ADDITIONAL DEVICES TO REDUCE EROSION DAMAGE AND CONTAIN POLLUTANTS WITHIN THE SITE IS LEFT TO THE DISCRETION OF THE FIELD ENGINEER. ADDITIONAL DEVICES TO BE INSTALLED TO RETAIN SEDIMENTS AND OTHER POLLUTANTS ON SITE.
- DESILING BASINS MAY NOT BE REMOVED OR MADE INOPERABLE BETWEEN NOVEMBER 1 AND APRIL 15 OF THE FOLLOWING YEAR WITHOUT THE APPROVAL OF THE BUILDING OFFICIAL.
- STORM WATER POLLUTION AND EROSION CONTROL DEVICES ARE TO BE MOORED, AS NEEDED, AS THE PROJECT PROGRESSES. THE DESIGN AND PLACEMENT OF THESE DEVICES IS THE RESPONSIBILITY OF THE FIELD ENGINEER. PLANS REPRESENTING CHANGES MUST BE SUBMITTED FOR APPROVAL IF REQUESTED BY THE FIELD OFFICIAL.
- EVERY EFFORT SHOULD BE MADE TO ELIMINATE THE DISCHARGE OF NON-STORM WATER FROM THE PROJECT SITE. THIS INCLUDES, BUT IS NOT LIMITED TO, CONTROLLED SEDIMENTS AND OTHER POLLUTANTS MUST BE RETAINED ON-SITE AND MAY NOT BE TRANSPORTED FROM THE SITE VIA SHEET FLOW, SHALLOWS, AREA DRAINS, NATURAL DRAINAGE COURSES, OR WIND.
- STOCKPILES OF FERTILIZERS AND OTHER TOXIC MATERIALS MUST BE PROTECTED FROM BEING TRANSPORTED FROM THE SITE BY THE FORCES OF WIND OR WATER.
- FUELS, OILS, SOLVENTS, AND OTHER TOXIC MATERIALS MUST BE STORED IN ACCORDANCE WITH THEIR LABELING AND ARE NOT TO CONTAMINATE THE SOILS AND SURFACE WATERS. ALL APPROVED STORAGE CONTAINERS ARE TO BE PROTECTED FROM THE WEATHER. SPILLS MUST BE CLEANED UP IMMEDIATELY AND DISPOSED OF IN A PROPER MANNER. SPILLS MAY NOT BE WASHED INTO THE DRAINAGE SYSTEM.
- EXCESS OR WASTE CONCRETE MAY NOT BE WASHED INTO THE PUBLIC WAY OR ANY OTHER DRAINAGE SYSTEM. PROCEEDING SHALL BE MADE AS REFINISHED CONCRETE WASTES ON-SITE UNTIL THEY CAN BE REUSED AS SOLID WASTE. DEVELOPERS/CONTRACTORS ARE RESPONSIBLE TO INSPECT ALL EROSION CONTROL DEVICES TO ENSURE THEY ARE BEING MAINTAINED PROPERLY. IF THERE IS A 50% OR GREATER PROBABILITY OF PREDICTED PRECIPITATION, AND AFTER THE CONSTRUCTION INSPECTION CHECKLIST AND INSPECTION LOG SHALL BE MAINTAINED AT THE PROJECT SITE AT ALL TIMES AND AVAILABLE FOR REVIEW BY THE BUILDING OFFICIAL. COPIES OF THE SELF-INSPECTION CHECK LIST AND INSPECTION LOGS ARE AVAILABLE UPON REQUEST.
- TRASH AND CONSTRUCTION RELATED SOLID WASTES MUST BE DEPOSITED INTO A COVERED RECEPTACLE TO PREVENT CONTAMINATION OF HUMAN AND ANIMAL DISPERSAL BY WIND.
- SEDIMENTS AND OTHER MATERIALS MAY NOT BE TRAVELED FROM THE SITE BY VEHICLE TRAFFIC. THE CONSTRUCTION ENTRANCE ROADWAYS MUST BE STABILIZED SO AS TO INHIBIT SEDIMENTS FROM BEING DEPOSITED INTO THE PUBLIC WAY. ACCIDENTAL DEPOSITIONS MUST BE SWEEP UP IMMEDIATELY AND MAY NOT BE WASHED DOWN BY RAIN OR OTHER MEANS.
- ANY SLOPES WITH DISTURBED SOILS OR DENuded OF VEGETATION MUST BE STABILIZED SO AS TO INHIBIT EROSION BY WIND AND WATER.
- AS THE ENGINEER/ISS OF RECORD, I HAVE SELECTED APPROPRIATE BMPs TO EFFECTIVELY MINIMIZE THE NEGATIVE IMPACTS OF THIS PROJECT'S CONSTRUCTION ACTIVITIES ON STORM WATER QUALITY. THE PROJECT OWNER AND CONTRACTOR ARE AWARE THAT THE SELECTED BMPs MUST BE INSTALLED, MONITORED, AND MAINTAINED TO ENSURE THEIR EFFECTIVENESS.

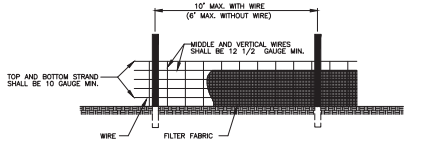

- NOTES**
- WIRE SHALL BE A MINIMUM OF 32" IN WIDTH AND SHALL HAVE A MINIMUM OF 6 LINE WIRES WITH 12" STAY SPACING.
 - FILTER FABRIC SHALL BE A MINIMUM OF 36" IN WIDTH AND SHALL BE FASTENED ADEQUATELY TO THE WIRE.
 - STEEL POST SHALL BE 3/4" IN HEIGHT AND BE OF THE SELF-FASTENER ANGLE STEEL TYPE.
 - WOOD POST SHALL BE 6"-8" IN HEIGHT AND 3" IN DIAMETER.

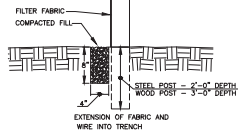

SILT FENCE DETAIL PER SE-1
N.T.S.

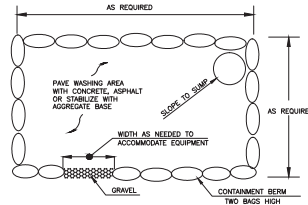

VEHICLE AND EQUIPMENT CLEANING PER NS-8
N.T.S.

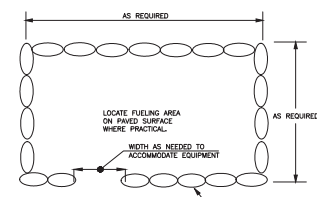

TYPICAL FUELING AREA PER NS-9
N.T.S.

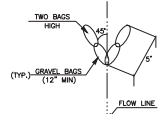

CHECK DAM PER SE-4
N.T.S.

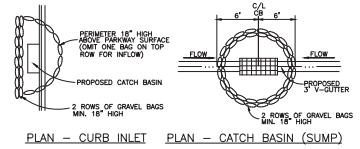

GRAVEL BAG DETAIL AT STORM DRAIN INLET PROTECTION PER SE-10
N.T.S.

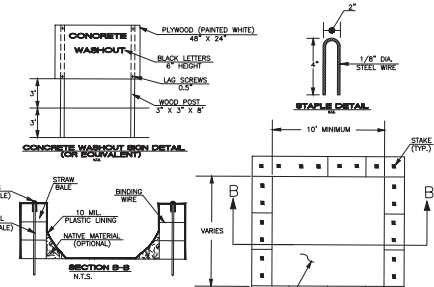

CONCRETE WASTE MANAGEMENT PER WM-8
N.T.S.

- NOTES:**
- ACTUAL LAYOUT DETERMINED IN THE FIELD.
 - THE CONCRETE WASHOUT SIGN SHALL BE INSTALLED WITHIN 30 FT. OF THE TEMPORARY CONCRETE WASHOUT FACILITY.

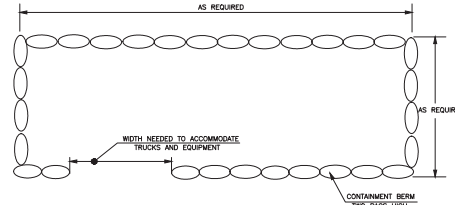

CONSTRUCTION WASTE STORAGE AREA AND CONSTRUCTION MATERIALS STORAGE AREA PER WM-5 AND WM-1
N.T.S.

EROSION CONTROL BMPs	TEMPORARY STABILIZATION CONTROL BMPs
EC-1 SCHEDULING	IS-1 STABILIZED CONSTRUCTION ENTRANCE/EXIT
EC-2 PRESERVATION OF EXISTING VEGETATION	IS-2 STABILIZED CONSTRUCTION ROADWAY
EC-3 HYDRULIC MULCH	IS-3 ENTRANCE/OUTLET THE WASH
EC-4 HYDRULIC MULCH	NON-STORMWATER MANAGEMENT BMPs
EC-5 SOIL BINDERS	NS-1 WATER COAGULATION PRACTICES
EC-6 STORM MULCH	NS-2 SEDIMENTATION OPERATIONS
EC-7 GEOTEXTILES AND MATS	NS-3 PAVING AND GRADING OPERATIONS
EC-8 WOOD MULCHING	NS-4 TEMPORARY STRIP CROSSING
EC-9 EROSION AND DRAINAGE	NS-5 CLEAR WATER DIVERSION
EC-10 VELOCITY DISPERSION DEVICES SHALLOWS	NS-6 SLOTTED ORIFICE/CHARGE
EC-11 STREAMBANK STABILIZATION	NS-7 POTABLE WATER/IRRIGATION
EC-12 SOIL PRESERVATION	NS-8 POTABLE WATER/IRRIGATION
EC-14 COMPOST BLANKET	NS-9 VEHICLE AND EQUIPMENT FUELING
EC-15 SOIL PRESERVATION/RESEEDING	NS-10 FERTILIZER AND PESTICIDE
EC-16 NON-VEGETATIVE STABILIZATION	NS-11 PILE DRIVING OPERATIONS
	CONCRETE BMPs
	NS-12 CONCRETE FINISHING
	NS-13 MATERIALS AND EQUIPMENT USE
	NS-14 DEMOLITION ADJACENT TO WATER
	NS-15 TEMPORARY BATCH PLANTS
	WASTE & MATERIAL MANAGEMENT BMPs
	WM-1 MATERIALS AND EQUIPMENT USE
	WM-2 MATERIAL USE AND STORAGE
	WM-3 WASTE MANAGEMENT
	WM-4 SPILL PREVENTION AND CONTROL
	WM-5 HAZARDOUS WASTE MANAGEMENT
	WM-6 CONCRETE WASTE MANAGEMENT
	WM-7 HAZARDOUS WASTE MANAGEMENT
	WM-8 LIQUID WASTE MANAGEMENT

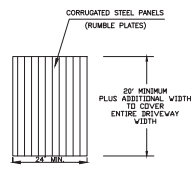

STABILIZED CONSTRUCTION ENTRANCE/EXIT RUMBLE PLATES
N.T.S.

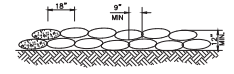

GRAVEL BAG BERM DETAIL 12" HIGH PER SE-6
N.T.S.



Know what's below. Call before you dig.

BENCHMARK:
CITY OF LOS ANGELES BENCHMARK NO. "21-02291"
LEAD AND TAG IN SOUTHWEST CURB RETURN KNOX STREET AND NORMANDE AVENUE, 13.5 FEET NORTH OF BORN SOUTH OF KNOX STREET
ELEVATION = 49.776 FEET (NAD '83 / 2014 ADL)

SOILS ENGINEER:

REV.	DESCRIPTION	DATE	APPR'D.



PLANS PREPARED UNDER THE SUPERVISION OF:
RICHARD STENZEL
P.E. 56155 - EXP. 12-31-20

ENGINEER:
TAEI Thienes Engineering, Inc.
CIVIL ENGINEERING & LAND SURVEYING
14348 FIRESTONE BOLLINGWOOD
LA BREA, CALIFORNIA 90638
TEL: (714) 851-4811 FAX: (714) 851-4113

OWNER:
COCONO PACIFIC GATEWAY LLC
1011 S. WINDY HILL
TORRANCE, CA 90502

CITY OF LOS ANGELES

EROSION CONTROL DETAILS

SHEET **7**
OF **7**

FOR
AMAZON DDX7 TORRANCE
5900 PLAZA STREET
LOS ANGELES

T.L. 208 361 3802